

BIRD AETHER 9

- Boost 148x12 SRAM Maxle, 180mm
- 210x55 Metric Shock with 30x8 Hardware both ends (Designed for Bearing Mounts)
- 1x Drivetrain optimised design, 52mm chainline
- Bolt on ISCG05 chainguide mounts
- 31.6mm Seat post with stealth dropper routing, 34.9mm seat clamp
- Full continuous external cable and hose routing
- Self locking collet pivot axle system
- 29" x 2.6" tyre clearance
- 160mm post disc brake mount
- Tapered ZS44 / ZS56 Headset
- Frame material: 6066-T6 Tubeset
- 73mm threaded bottom bracket shell
- Anti-Squat optimised for pedalling efficiency
- Progressive shock curve for support and pop

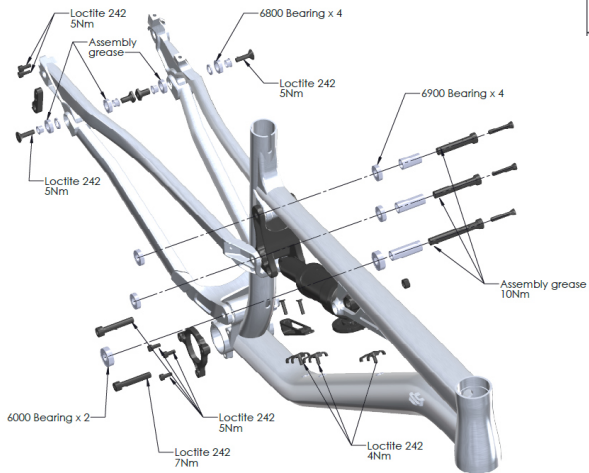
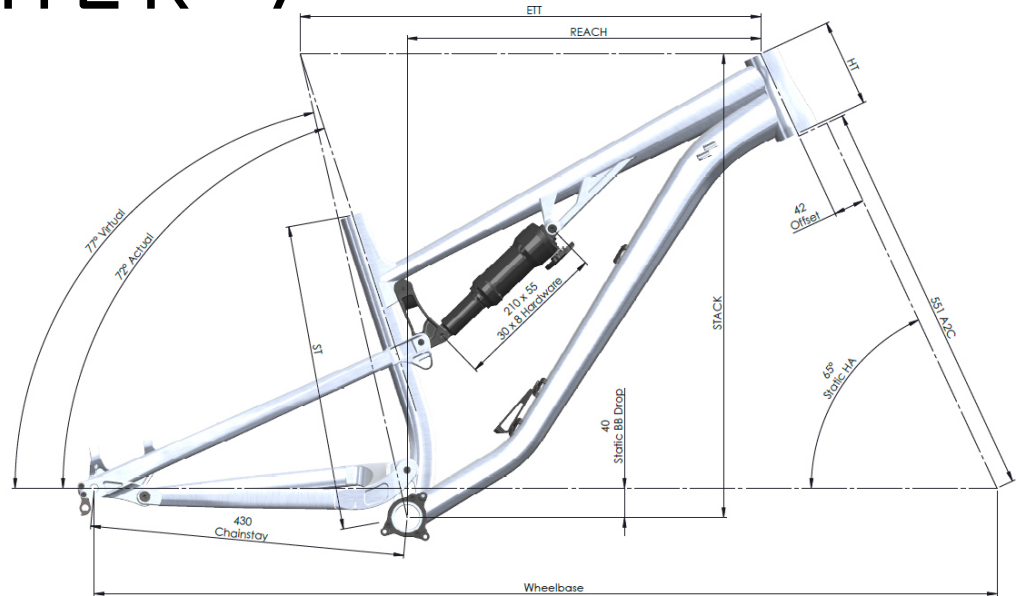

	M	ML	L	XL
ST	395	420	445	470
ETT	605	630	655	680
Reach	461	484	507	529
Stack	625	634	643	652
Wheelbase	1208	1235	1262	1289
HT	110	120	130	140
Standover	354	354	361	361

HA [static]	65
HA [sagged]	64.8
SA [Virtual]	77
SA [Actual]	72
CS	430
BB drop	40
BB drop [sagged]	81
BB height	330
BB height [sagged]	289
A2C	551
Lower HeadSet	4
Offset	42

Size	5'2"	5'6"	5'10"	6'2"	6'4"
S	158cm	168cm	178cm	188cm	193cm
M					
ML					
L					
XL					